

# Soakwell

Rapid Flow

Easy to install!

## D.I.Y. Soakwell System

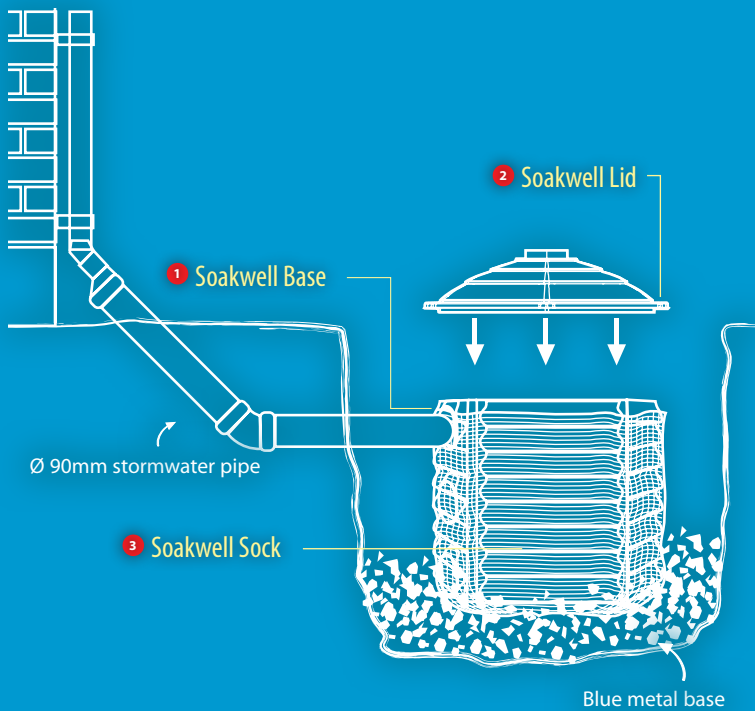

### Soakwell Lid Features

- Lightweight, easier to install
- Strong, manufactured in high strength reinforced polymer
- Easily assembled to Soakwell Base
- Safer to handle and easy to lift

### Soakwell System Components



### Clears water in sandy soil fast!

- Super strong corrugated beehive design
- Designed to withstand ground pressure
- Knock out centre or bottom inlet/outlet for controlled flow
- Drainage slots designed to provide maximum water flow to surrounding soil

For more information  
[www.reln.com.au](http://www.reln.com.au)

**RELN**

# Soakwell

## Rapid Flow

### D.I.Y. Soakwell System Planner

Design your own drainage system with Soakwell

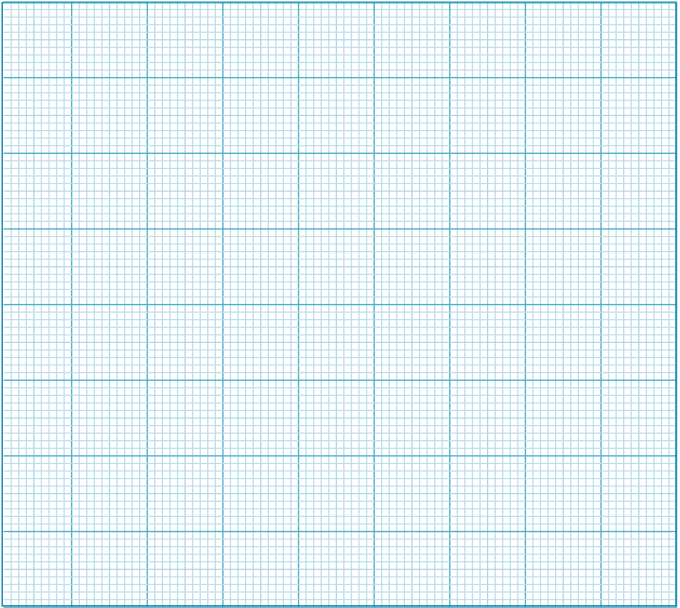

COMPONENT		QTY	CHECK
1 Soakwell Base			<input type="checkbox"/>
2 Soakwell Lid			<input type="checkbox"/>
3 Soakwell Sock			<input type="checkbox"/>

### Installation Instructions for Soakwell System

Easy Installation in 3 simple steps

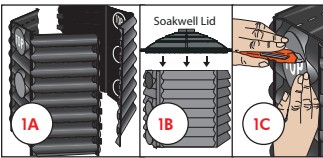

#### 1. ASSEMBLE BASE AND SOAKWELL LID

- A. Assemble sides of the Soakwell Base by inserting tabs and pushing lock clips together both sides TOP up.
- B. Cut out TOP inlet hole.
- C. Fit NEW Soakwell Lid to the Base.

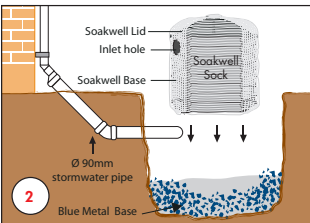

#### 2. FIT SOAKWELL SOCK

Fit Soakwell Sock over the top of assembled Base and Lid. Cut inlet hole in Sock to fit pipe through.

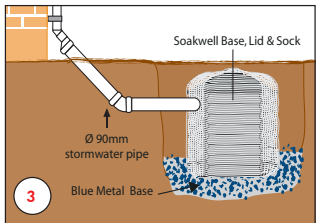

#### 3. INSTALL

Place assembled Soakwell in a one metre hole with a base of 100mm blue metal. Connect to storm water pipe. Backfill hole and cover.

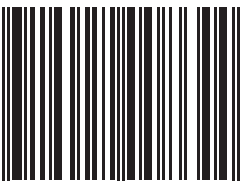

9 319022 008644 >

For further information  
[www.reln.com.au](http://www.reln.com.au)